

Freeman Roofing Corrugate	
0.4mm	Colorsteel® Endura
0.55mm	Colorsteel® Endura
0.4mm	Colorsteel® Maxx
0.55mm	Colorsteel® Maxx
0.4mm	Zincalume®
0.55mm	Zincalume®

Wall cladding (non cavity shown) ———→  
 Vapour barrier/ Wall Underlay ———→  
 overlap as shown

Apron flashing to match  
 Corrugate material

Freeman Roofing Corrugate

Soft Edge

Vapour barrier/ Roofing Underlay  
 to underside of roof cladding

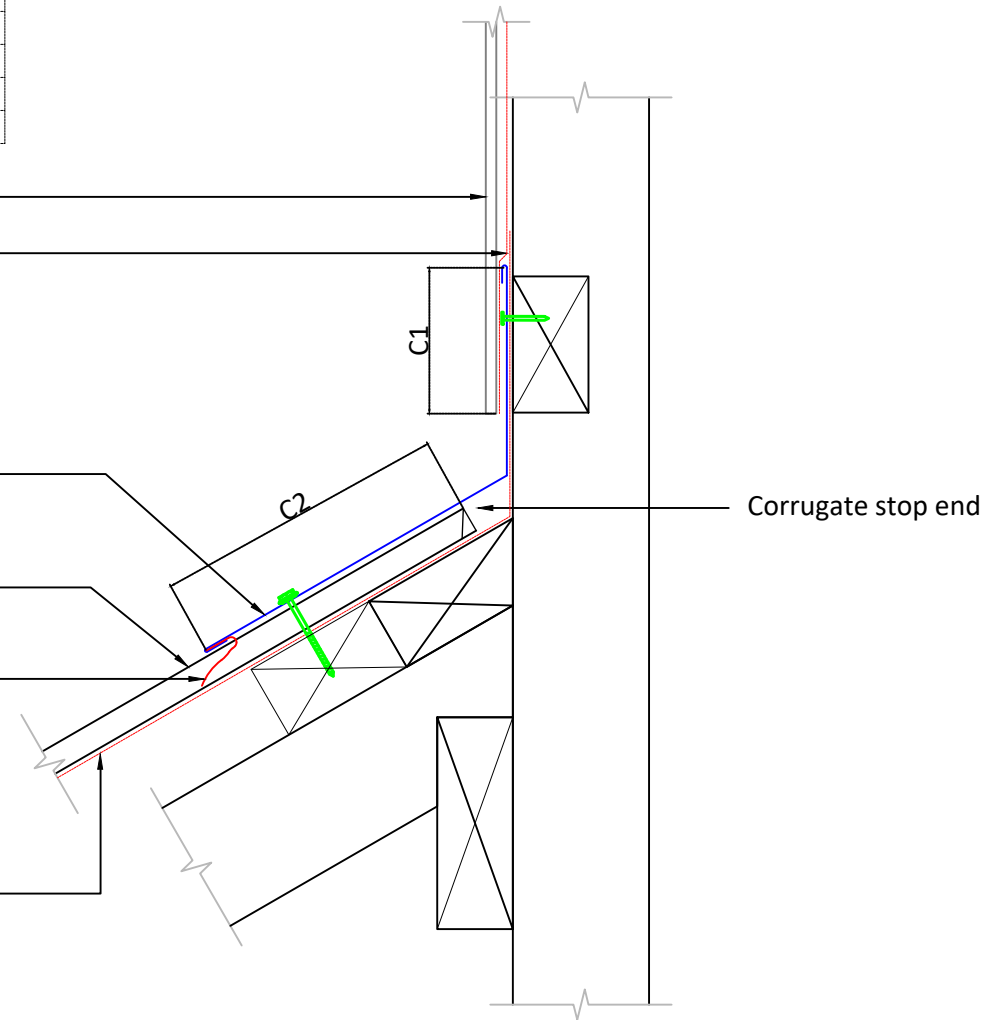

**Notes:**

These details are required to be fixed to allow thermal movement .

**Category A:**

Low, Medium or High Wind Zones, all pitches  
 Very High and Extra High Wind Zones where the pitch is equal to or greater than 10°.

**Category B:**

Very High where the pitch is less than 8°, and  
 Extra High Wind Zones all pitches.

**Category C:**

SED Wind Zones up to 60 m/s all pitches.

Category			
Dimension	A	B	C
C2	130mm	200mm	200mm
C1 (Smooth)	50mm	75mm	75mm
C1 (Profiled)	75mm	100mm	125mm