

Freeman Roofing Corrugate	
0.4mm	Colorsteel® Endura
0.55mm	Colorsteel® Endura
0.4mm	Colorsteel® Maxx
0.55mm	Colorsteel® Maxx
0.4mm	Zincalume®
0.55mm	Zincalume®

Wall cladding (non cavity shown)

Apron flashing to match
Corrugate material

Freeman Roofing Corrugate

Selected fixings

Undersoaker

Vapour barrier/ Roofing Underlay
to underside of roof cladding

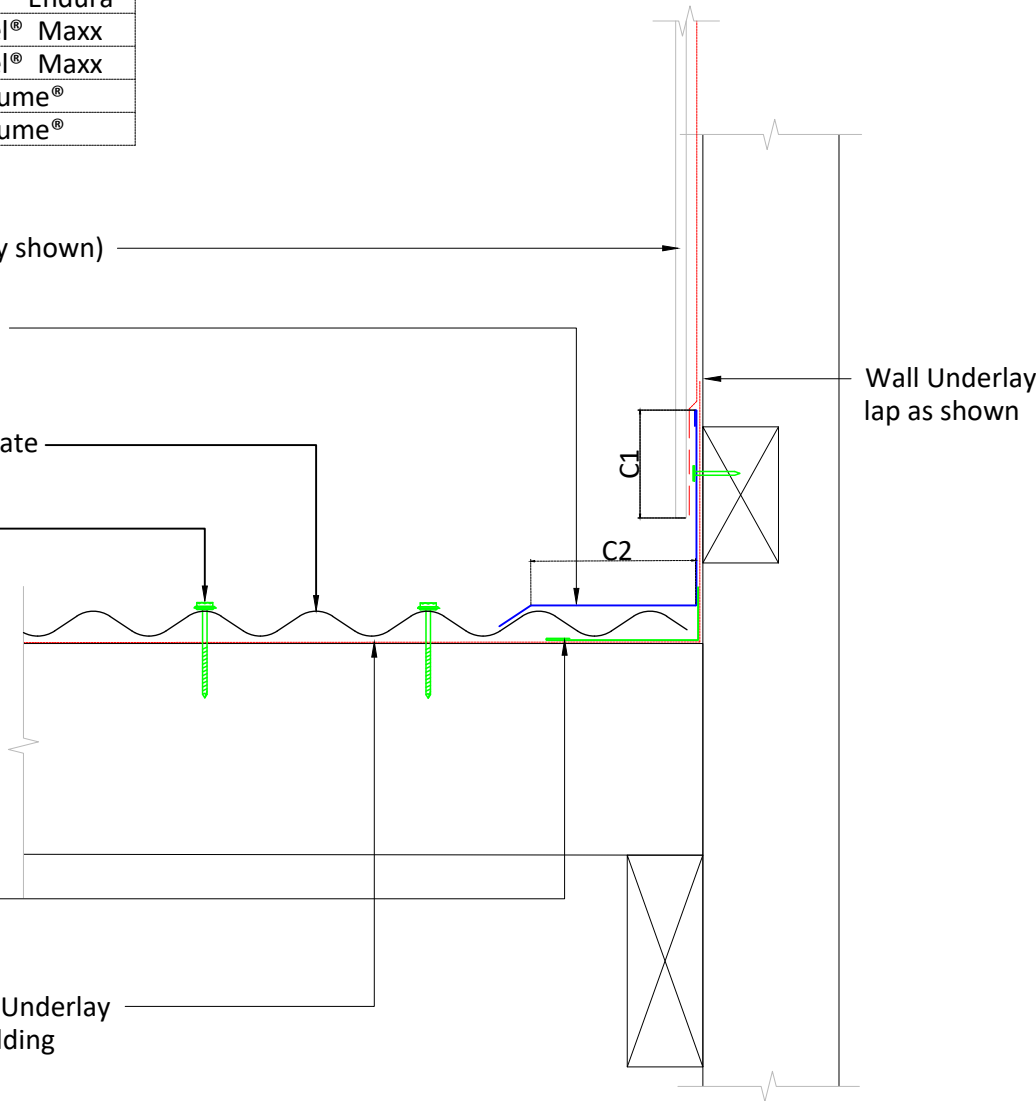

Notes:

These details are required to be fixed to allow thermal movement .

Category A:

Low, Medium or High Wind Zones, all pitches
Very High and Extra High Wind Zones where the pitch is equal to or greater than 10°.

Category B:

Very High where the pitch is less than 8°, and
Extra High Wind Zones all pitches.

Category C:

SED Wind Zones up to 60 m/s all pitches.

Dimension	Category		
	A	B	C
C2	2 Crests	2 Crests	3 Crests
C1 (Smooth)	50mm + hem or 75mm	75mm + hem or 10mm	100mm + hem or 125mm
C1 (Profiled)	75mm + hem or 100mm	100mm + hem or 125mm	125mm + hem