

Wall cladding (non cavity shown)

Vapour barrier/ Wall Underlay

Vapour barrier/ Wall Underlay overlap as shown

Freeman Roofing Six Rib	
0.4mm	Colorsteel® Endura
0.55mm	Colorsteel® Endura
0.4mm	Colorsteel® Maxx
0.55mm	Colorsteel® Maxx
0.4mm	Zincalume®
0.55mm	Zincalume®

BMT apron flashing to match Six Rib material

Freeman Group Ltd Six Rib

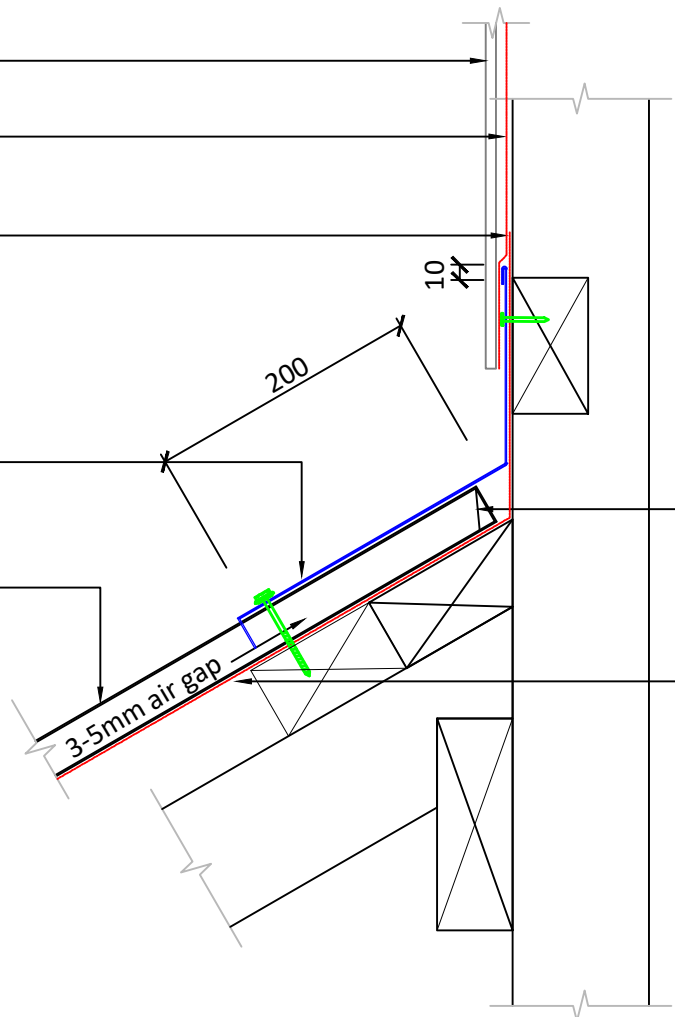

Six Rib stop end

Vapour barrier/ Roofing Underlay to underside of roof cladding

Notes:
These details are required to be fixed to allow thermal movement .



Family owned since 1956
Whangārei | Tauranga | Wellington | Nelson | Blenheim
| Ashburton | Timaru | Dunedin | Wānaka | Queenstown



Six Rib Residential
Upper Apron Flashing

Scale:
1 : 5 @ A4

Issue Date:
21/11/2023

Document Name:
SRQ-UA1